

AMX208-d3 Mass Spectrometry Technical Support Center

Author: BenchChem Technical Support Team. **Date:** December 2025

Compound of Interest

Compound Name: AMX208-d3

Cat. No.: B12417568

[Get Quote](#)

This technical support center provides troubleshooting guidance and frequently asked questions for researchers, scientists, and drug development professionals working with the analysis of **AMX208-d3** and other small molecules by mass spectrometry.

Frequently Asked Questions (FAQs)

Q1: What are the most common causes of poor signal intensity for my analyte?

A1: Poor signal intensity, characterized by weak or undetectable peaks, can stem from several factors.^[1] These include:

- **Inappropriate Sample Concentration:** If the sample is too dilute, the signal may be too low to detect. Conversely, a highly concentrated sample can lead to ion suppression, also reducing the signal.^[1]
- **Suboptimal Ionization Efficiency:** The choice of ionization technique (e.g., ESI, APCI, MALDI) is critical and can significantly impact the signal intensity for your specific analyte.^[1]
- **Instrument Calibration and Tuning:** Regular tuning and calibration of the mass spectrometer are necessary to ensure the instrument is operating at its optimal performance.^[1]

Q2: My mass accuracy is poor. What should I check?

A2: Inaccurate mass determination can lead to incorrect compound identification. Key areas to investigate are:

- **Mass Calibration:** The instrument requires regular mass calibration with appropriate standards to ensure accurate mass measurements.^[1] An incorrect or outdated calibration is a common source of mass errors.
- **Instrument Maintenance:** Contamination or a drift in instrument performance over time can negatively affect mass accuracy and resolution. Adhering to the manufacturer's recommended maintenance schedule is crucial.

Q3: I am seeing a lot of background noise in my spectra. What are the likely sources?

A3: A high baseline or excessive noise can obscure true analyte peaks. Potential causes include:

- **Contaminated Solvents or Gases:** Impurities in solvents or carrier gases can introduce background noise.
- **Leaks in the System:** Air leaks, particularly at fittings and seals, can introduce atmospheric gases like nitrogen and oxygen into the mass spectrometer, leading to a high background.
- **Column Bleed:** In GC-MS, operating a column above its recommended temperature limit can cause the stationary phase to degrade and "bleed," creating a rising baseline and extraneous peaks.
- **Sample Contamination:** Contaminants from sample preparation, such as polymers from plasticware (e.g., siloxanes, phthalates), can appear as background ions.

Q4: Why am I seeing unexpected peaks in my mass spectrum?

A4: The presence of unexpected peaks can be due to several factors:

- **Contamination:** Environmental contaminants or impurities from the sample matrix are a frequent cause of extraneous peaks.
- **Carryover:** Residual sample from a previous injection can lead to "ghost peaks" in the current analysis.

- In-source Fragmentation or Adduct Formation: The analyte itself may be fragmenting in the ion source or forming adducts with salts or solvents (e.g., sodium, potassium).

Troubleshooting Guides

Issue 1: No Analyte Peaks Detected

Symptoms:

- The total ion chromatogram (TIC) is flat or shows only solvent peaks.
- No peak is observed at the expected m/z for **AMX208-d3**.

Possible Causes and Solutions:

Cause	Troubleshooting Steps
Sample Preparation Issue	- Verify the concentration of AMX208-d3 in the sample.- Review the sample preparation protocol for any errors.- Prepare a fresh sample to rule out degradation.
Injection Problem	- Check for a blocked or improperly installed syringe.- Ensure the autosampler is correctly accessing the sample vial.- Manually inject a standard to confirm instrument function.
Instrument Settings	- Confirm that the mass spectrometer is set to acquire data in the correct m/z range for AMX208-d3.- Verify that the ionization source parameters (e.g., temperatures, gas flows) are appropriate for the analyte and flow rate.
Hardware Failure	- Check for a blown filament in the ion source.- Ensure the detector is functioning correctly by checking the instrument's diagnostic tune.

Issue 2: Poor Peak Shape (Tailing or Fronting)

Symptoms:

- Peaks in the chromatogram are asymmetrical, with a gradual slope on the trailing or leading edge.

Possible Causes and Solutions:

Cause	Troubleshooting Steps
Column Overload	- Dilute the sample and reinject. Tailing can occur if the amount of analyte is too high for the column's capacity.
Active Sites in the System	- Deactivate the system by injecting a standard known to be sensitive to active sites.- Check for contamination in the inlet liner or the front of the column. Trimming the first few centimeters of the column may help.
Inappropriate Flow Rate	- Optimize the carrier gas flow rate for the column dimensions and stationary phase.
Poor Chromatography	- Ensure the mobile phase (for LC-MS) or temperature program (for GC-MS) is optimized for the analyte.

Issue 3: Inconsistent or Drifting Retention Times

Symptoms:

- The retention time of the **AMX208-d3** peak varies significantly between injections.

Possible Causes and Solutions:

Cause	Troubleshooting Steps
Leaks in the Chromatographic System	- Perform a leak check on all fittings from the injector to the mass spectrometer interface.
Unstable Flow Rate or Temperature	- Verify that the gas or solvent flow rates are stable.- Ensure the column oven temperature is consistent and not fluctuating.
Column Degradation	- Over time, the column's stationary phase can degrade, leading to changes in retention. Consider replacing the column if performance continues to decline.
Changes in Mobile Phase Composition	- For LC-MS, ensure the mobile phase composition is accurate and consistent. Premixing solvents can sometimes improve stability.

Experimental Protocols

Standard Protocol for AMX208-d3 Analysis by LC-MS

- Sample Preparation:
 - Accurately weigh 1 mg of **AMX208-d3** standard and dissolve in 1 mL of methanol to create a 1 mg/mL stock solution.
 - Prepare a series of calibration standards by serially diluting the stock solution with a 50:50 mixture of acetonitrile and water.
 - For experimental samples, perform a protein precipitation step by adding three parts of cold acetonitrile to one part of the sample, vortex, and centrifuge.
 - Transfer the supernatant to a clean vial for analysis.
- Liquid Chromatography (LC) Parameters:
 - Column: C18 reverse-phase column (e.g., 2.1 mm x 50 mm, 1.8 µm particle size).

- Mobile Phase A: 0.1% formic acid in water.
- Mobile Phase B: 0.1% formic acid in acetonitrile.
- Gradient: Start at 5% B, ramp to 95% B over 5 minutes, hold for 2 minutes, and then return to initial conditions and equilibrate for 3 minutes.
- Flow Rate: 0.4 mL/min.
- Injection Volume: 5 μ L.
- Mass Spectrometry (MS) Parameters:
 - Ionization Mode: Electrospray Ionization (ESI), Positive.
 - Capillary Voltage: 3.5 kV.
 - Gas Temperature: 325°C.
 - Gas Flow: 8 L/min.
 - Scan Range: m/z 100-1000.
 - Data Acquisition: Full scan mode for qualitative analysis and Selected Ion Monitoring (SIM) or Multiple Reaction Monitoring (MRM) for quantification, targeting the specific m/z of **AMX208-d3**.

Visualizations

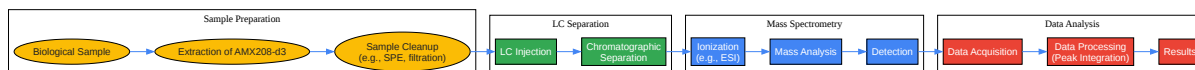

[Click to download full resolution via product page](#)

Caption: A typical experimental workflow for LC-MS analysis.

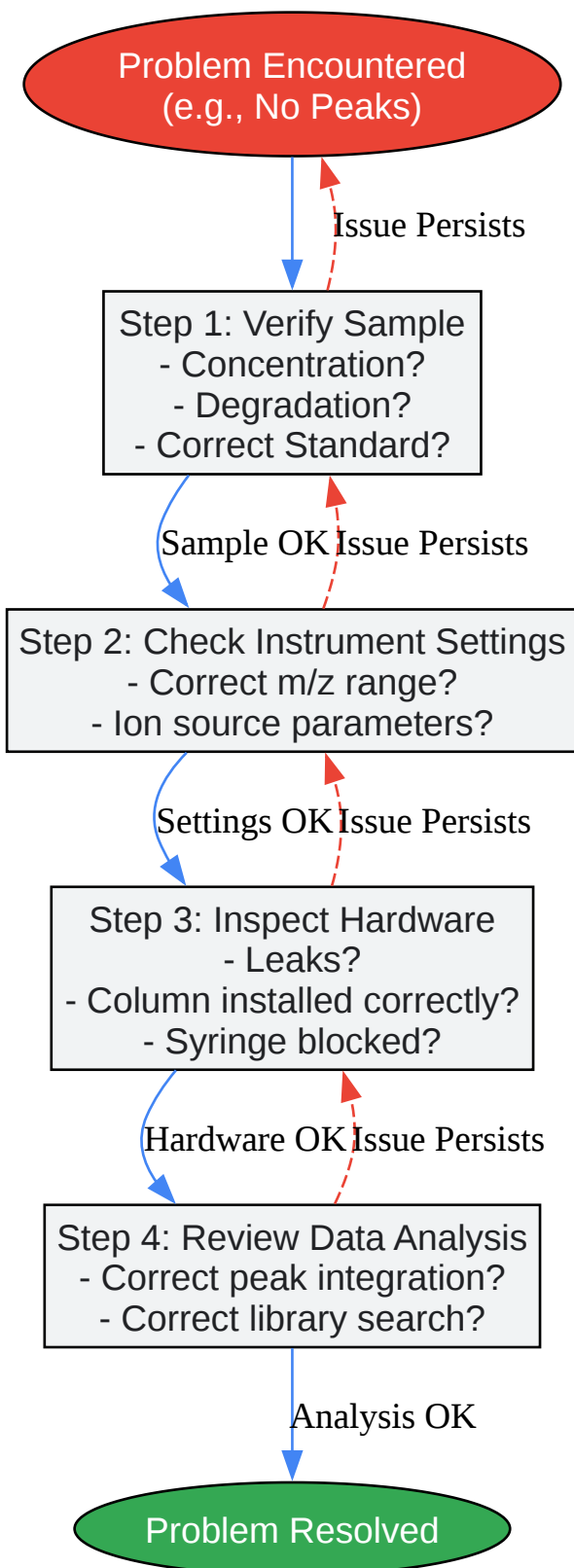

[Click to download full resolution via product page](#)

Caption: A logical workflow for troubleshooting common mass spec issues.

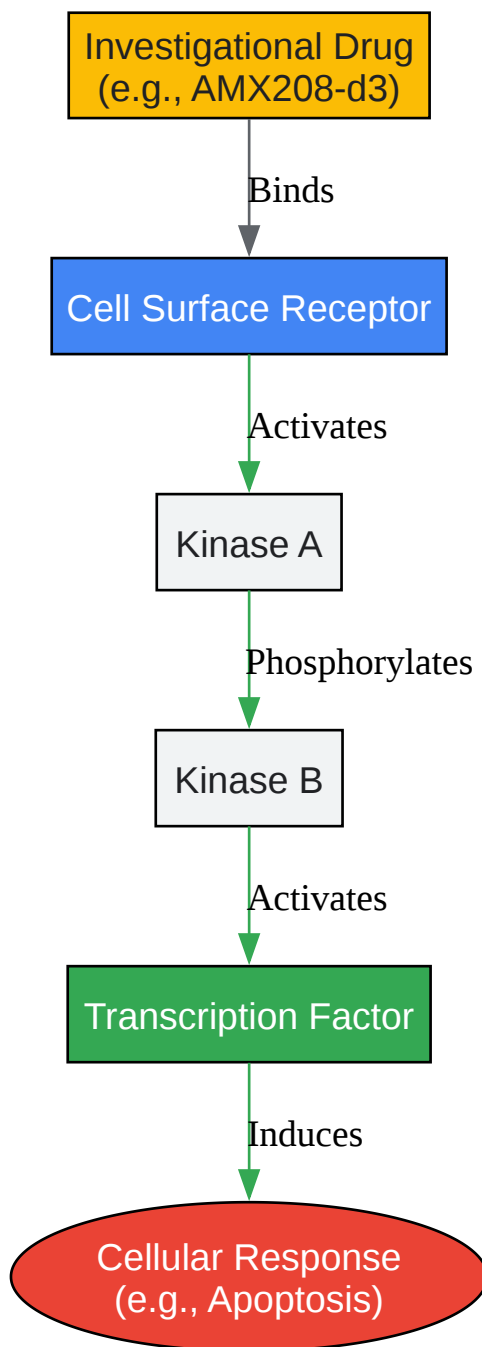

[Click to download full resolution via product page](#)

Caption: A hypothetical signaling pathway for an investigational drug.

Need Custom Synthesis?

BenchChem offers custom synthesis for rare earth carbides and specific isotopic labeling.

Email: info@benchchem.com or [Request Quote Online](#).

References

- 1. gmi-inc.com [gmi-inc.com]
- To cite this document: BenchChem. [AMX208-d3 Mass Spectrometry Technical Support Center]. BenchChem, [2025]. [Online PDF]. Available at: [https://www.benchchem.com/product/b12417568#troubleshooting-amx208-d3-mass-spec-results]

Disclaimer & Data Validity:

The information provided in this document is for Research Use Only (RUO) and is strictly not intended for diagnostic or therapeutic procedures. While BenchChem strives to provide accurate protocols, we make no warranties, express or implied, regarding the fitness of this product for every specific experimental setup.

Technical Support: The protocols provided are for reference purposes. Unsure if this reagent suits your experiment? [[Contact our Ph.D. Support Team for a compatibility check](#)]

Need Industrial/Bulk Grade? [Request Custom Synthesis Quote](#)

BenchChem

Our mission is to be the trusted global source of essential and advanced chemicals, empowering scientists and researchers to drive progress in science and industry.

Contact

Address: 3281 E Guasti Rd
Ontario, CA 91761, United States
Phone: (601) 213-4426
Email: info@benchchem.com